

Why do we use Infill Panels?

Infills are used to fill in the space between your cabinets and your walls. In a perfect world all walls would be 100% square and we could simply place cabinets right next to the wall, however this is not the case and even in brand new homes you will find small discrepancies in wall angles. Below are two examples of common wall scenarios (exaggerated for effect). Infills are shown in red.

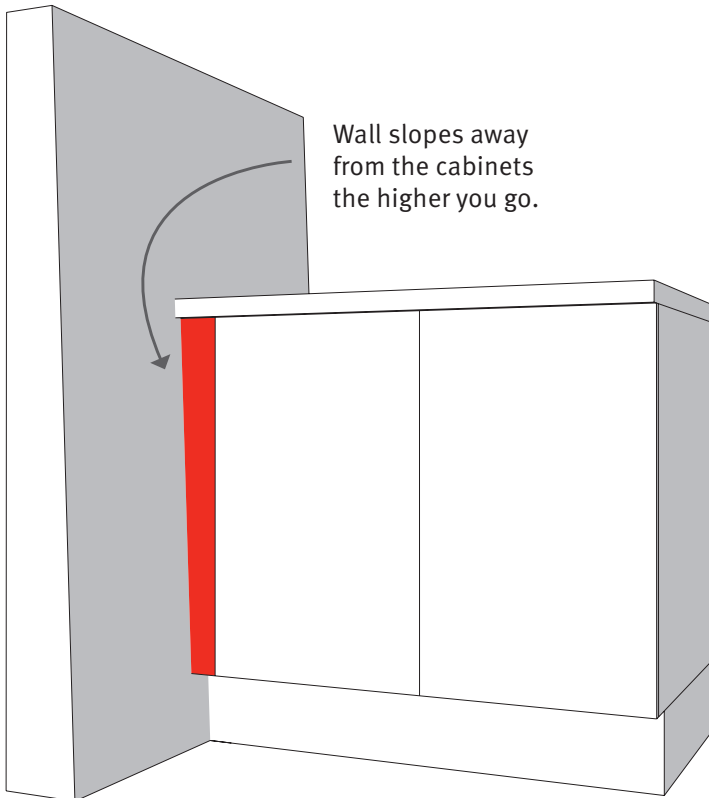

Designing for Infill Panels

U-Install-It Kitchens offer two types of infill panel.

Setback Infill

Sits level with the front of the cabinet without the door on.

Flush Infill

Level with the front of the cabinet with the door on.

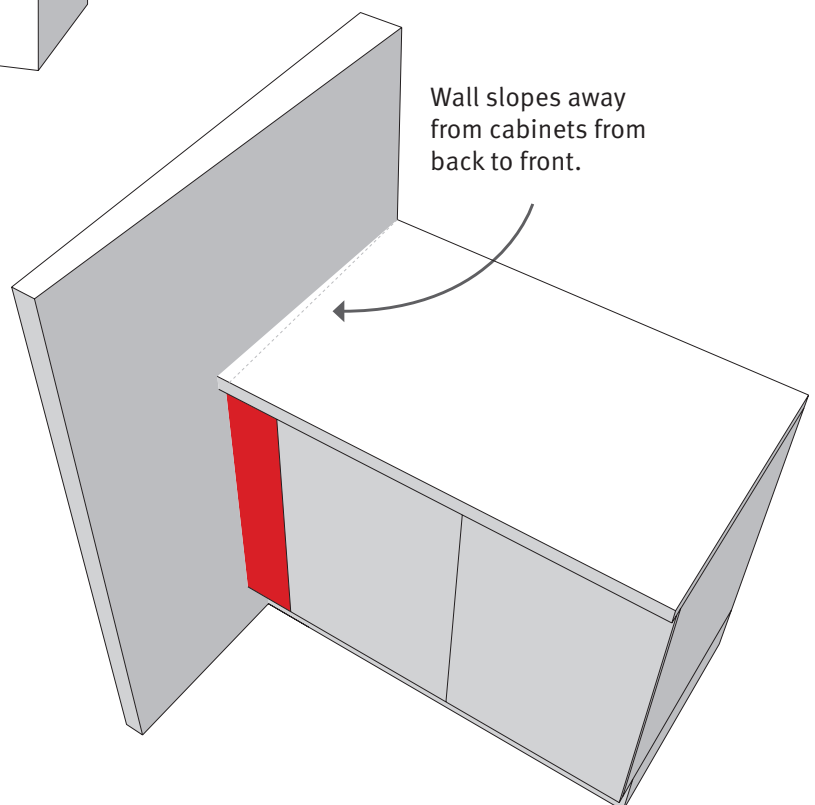

IMPORTANT TIP

Infill panels are designed to be cut down to size during installation, therefore we offer our standard infill panels at a minimum of 100mm wide. This should be more than enough to cover most scenarios.

When planning your kitchen we recommend you plan your infills to be at least 40mm wide. This will make positioning the cabinet and infill much more manageable during installation.

In older houses you'll be surprised by how "out" some walls can be!

How to install Infill Panels?

Infills are always installed after your cabinets have been placed in position. Regardless of choosing Flush or Setback infills, the installation process is almost the same. See below for a full guide on how to correctly install your infill panels.

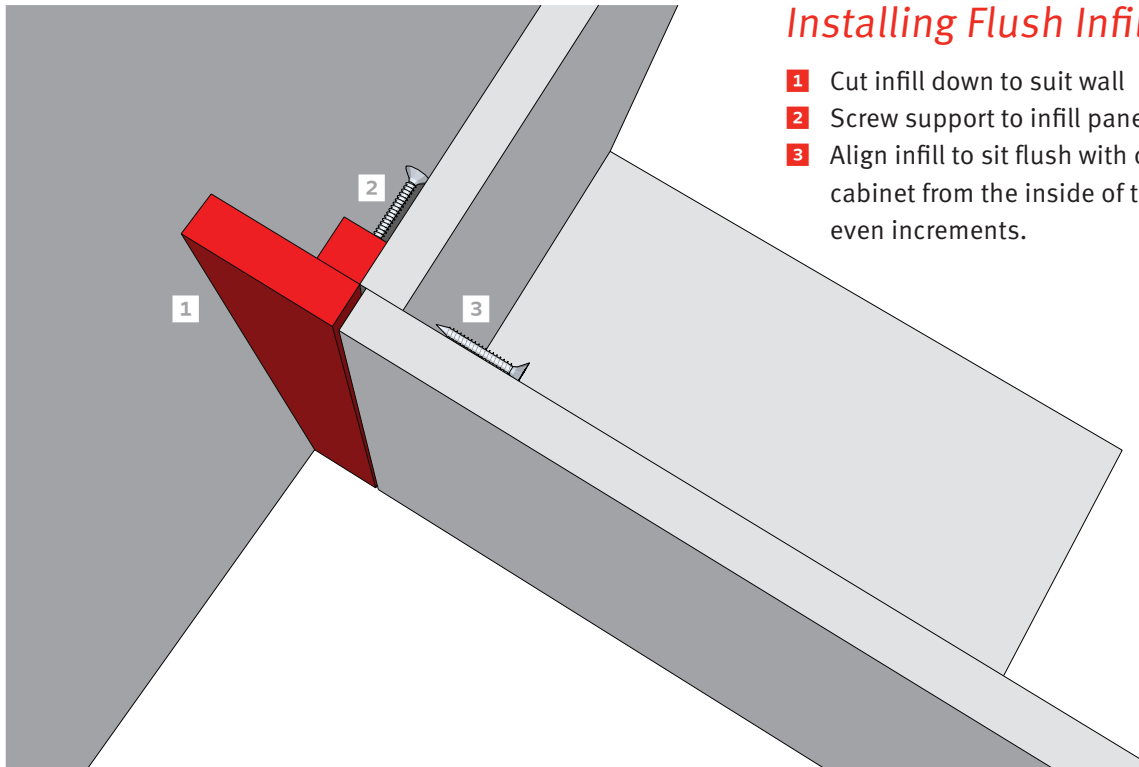

Installing Flush Infills

- 1 Cut infill down to suit wall
- 2 Screw support to infill panel at even increments
- 3 Align infill to sit flush with door and screw infill to cabinet from the inside of the cabinet, again at even increments.

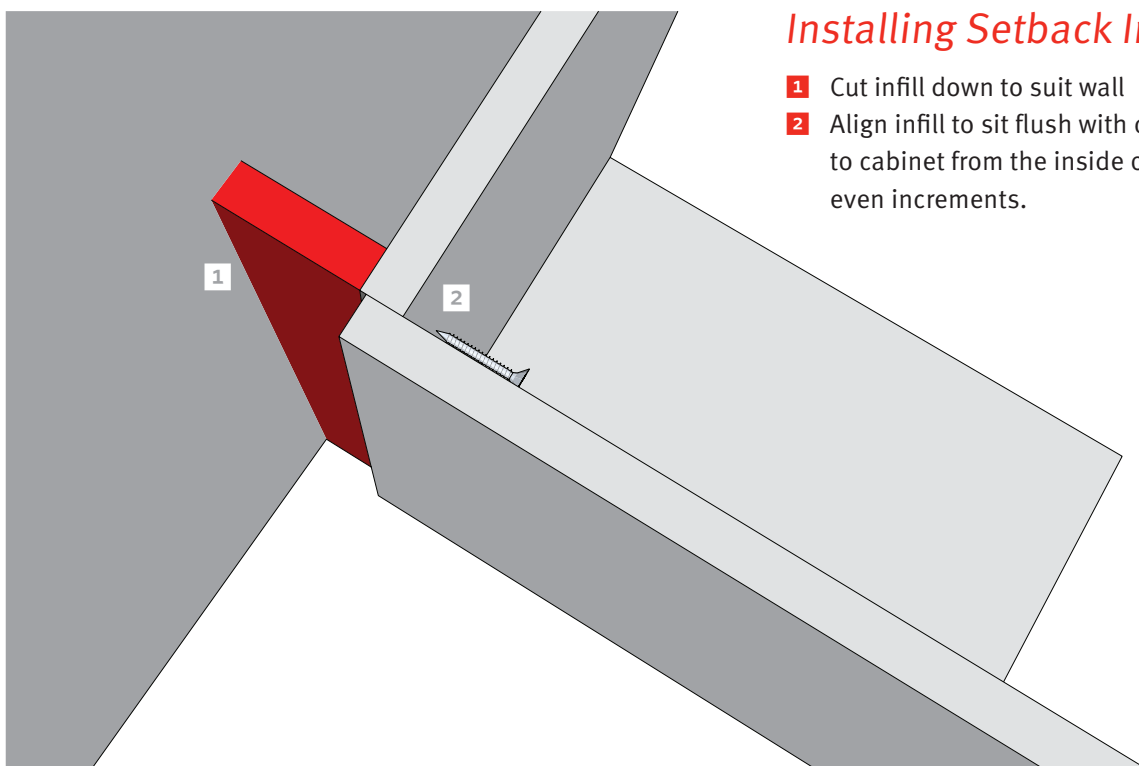

Installing Setback Infills

- 1 Cut infill down to suit wall
- 2 Align infill to sit flush with cabinet and screw infill to cabinet from the inside of the cabinet, again at even increments.